

Architectural Series

100W Profile

(ver. 2020/06)



SOURCE

- 100W LED COB
- Source life expectancy: > 50.000 h

	Luminous flux		Colour rendering		
	PR (ZS)	PR (ZW)	CRI	TLCI	TM-30
WW	4'316 lm	7'360 lm	>97	97	94
CW	4'905 lm	8'315 lm			
NW	2'335 lm	7'898 lm			

CONTROL

- Protocols: DMX512, RDM (DALI optional)
- Local potentiometer
- Reversible graphics display with standby-shutdown function

	DMX Channels
WHITE	1 / 2 / 3 ch

OPTICS

- High-quality glass lens optics
- Focus: manual
- Gobo size: M or B

	Beam	
	PR (ZS)	PR (ZW)
WHITE	20°-38°	35°-50°

HOUSING

- Highly resistant body in extruded aluminum
- Finishing: Black
- IP 20

CONNECTION

- Power connector: Chassis PowerCON In/Out
- Additional cable: 2m H05RN-F cable with powerCON female cable connector
- DMX: XLR 5-pole In/Out panel connectors

COMPLIANCE

- CE
- EN 60598-1; EN 60598-2-17
- SSL Licensing Program
- Manufactured in Italy with Quality System ISO 9001:2015

SOFTWARE FUNCTIONS

- ESD: 8 or 16bit extra soft dimming
- 2 selectable dimmer curves
- Adjustable delay in turning on and off
- PWM LED 500Hz-20KHz
- Led boost
- Storage and factory recovery
- Upgradable Firmware via DMX/USB tool

THERMAL MANAGEMENT

- Wide ventilation slots for better LED cooling with selectable fan speed in: "standard", "silent" and "auto" or DMX regulated
- High efficiency heat pipe cooling system
- No heat load from LED engine towards electronic and vice-versa avoiding the risk of failure due to overheating
- Ta max 40°C

ELECTRICAL

- Power supply: 100-240 V – 50/60 Hz
- Power consumption: 100 W
- PF>0.94/230VAC PF>0.98/115VAC at full load

OPTIONS

- Pole Operated Yokes
- ARC Motorized Yokes DMX 512

DIMENSIONS

PR (ZS)	6.2 Kg	396*336*540 mm
PR (ZW)	6.0 Kg	396*336*450 mm

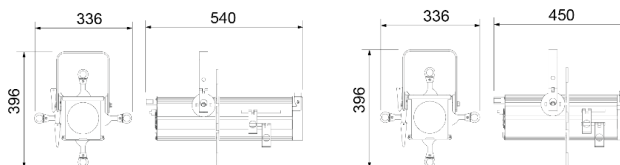

DMX chart

	WHITE		
	1CH	2CH	3CH
	8 BIT	8 BIT	16 BIT
1 ch	DIMMER	DIMMER	DIMMER
2 ch		STROBO	DIMMER FINE
3 ch			STROBO

Architectural Series

100W Profile

(ver. 2020/06)



4 m	6 m	8 m	10 m	12 m
-----	-----	-----	------	------

Model	Type	CT	CRI	Beam	Lux	Ø Beam	Lux	Ø Beam	Lux	Ø Beam	Lux	Ø Beam	Lux	Ø Beam	(measure at)
PR LED C100 ZS	WW	3000K	97	20°	1955	1,4	869	2,1	489	2,8	313	3,5	217	4,2	3000K
				38°	980	2,7	436	4,1	245	5,5	157	6,8	109	8,2	
	NW	4000K	97	20°	2111	1,4	938	2,1	528	2,8	338	3,5	235	4,2	4000K
				38°	1058	2,7	470	4,1	265	5,5	169	6,8	118	8,2	
	CW	5600K	97	20°	2222	1,4	988	2,1	556	2,8	356	3,5	247	4,2	5600K
				38°	1114	2,7	495	4,1	278	5,5	178	6,8	124	8,2	
PR LED C100 ZW	WW	3000K	97	35°	1255	2,5	558	3,8	314	5,0	201	6,3	139	7,5	3000K
				50°	855	3,7	380	5,6	214	7,4	137	9,3	95	11,1	
	NW	4000K	97	35°	1350	2,5	600	3,8	337	5,0	216	6,3	150	7,5	4000K
				50°	918	3,7	408	5,6	229	7,4	147	9,3	102	11,1	
	CW	5600K	97	35°	1421	2,5	631	3,8	355	5,0	227	6,3	158	7,5	5600K
				50°	966	3,7	429	5,6	242	7,4	155	9,3	107	11,1	